

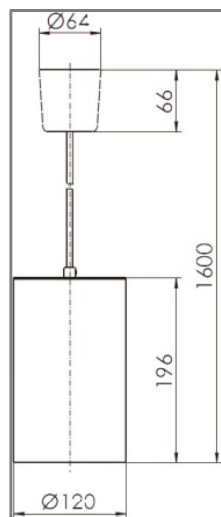

The pendant and / or ceiling luminaire **Flip** is impressive through its clarity of shape and arrangement of colour. The cylindrical luminaire unit made of PMMA with a satin finish combined with vivid colours emphasises the characteristic of this luminaire. Blue, red, yellow or opal, the luminaire adds an accent, regardless of whether it is above a counter, a table or serving as room, corridor and accent lighting. Flip is simply there.

### Dimensions



Type	Colour
Flip 140-E27 Opal	Opal
Flip 140-E27 SBL	Blue
Flip 140-E27 SRT	Red
Flip 140-E27 ZKG	Yellow

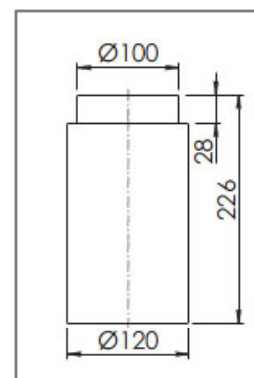

Type	Colour
Flip-D 140-E27 Opal	Opal
Flip-D 140-E27 SBL	Blue
Flip-D 140-E27 SRT	Red
Flip-D 140-E27 ZKG	Yellow



Photo: Dmitriy Koksharov - Fotolia

Don't hesitate to contact our experts: Mónika Hosó (T: (06 1) 450 2701); István Hajdrik (T: (06 1) 450 2712); Balázs Lévai (T: (06 1) 450 2711); György Jánoska (T: 06 1) 450-2714)